

# XP

## DS1015 HIGH TORQUE/ HIGH SPEED DIGITAL CORELESS SERVO

Product No. #29167

## DS1313 HIGH PERFORMANCE DIGITAL CORELESS SERVO

Product No. #29166

### Introduction

Congratulations on your purchase of Team Associated's XP Digital Servo. This digital servo is a race proven product featuring numerous enhancements that improve vehicle control and on track performance. Equipped with an all-new ultra precise metal gear and an advanced microprocessor, this servo provides precise outputs and ultra fast signal pulse response. Its state-of-the-art aluminum heat sink mid case lowers operating temperatures for fade-free performance.

THOROUGHLY READING THIS INSTRUCTION MANUAL PRIOR TO INSTALLATION IS HIGHLY RECOMMENDED.

### Features

- Equipped with ultra precise metal gears.
- Advanced microprocessor that can process signals faster and with more precision.
- Aluminum heat sink mid case dissipates heat build-up for fade free performance.
- Advanced case design enhances structural integrity to deliver dependable power and accuracy.
- Higher holding power with less angular errors compared to other leading brands.
- Superior torque output with low current consumption.
- Water and dust resistant.

### Contents

Product name	DS1015	DS1313
Servo	#29167	#29166
Servo Connector	JR Type	JR Type
Servo Horn	Super Rigid	Super Rigid
Servo Hardware	Horn Screw x 1	Horn Screw x 1
	Mounting Screws x 4	Mounting Screws x 4
	Eyelet-Brass x 4	Eyelet-Brass x 4
	Rubber Grommet ( Damper ) x 4	Rubber Grommet ( Damper ) x 4
	Flanged Nut x 4	Flanged Nut x 4

### Specifications

Product name	DS1015	DS1313
Product No.	#29167	#29166
Motor	Coreless	Coreless
Gear	Metal	Metal
Case	Heat Sink	Heat Sink
Dim. ( LxWxH )mm	41.8 x 20.6 x 39.6	41.8 x 20.6 x 39.6
Weight ( g/oz )	66 / 2.328	66 / 2.328
Torque ( Kg-cm/oz-in )@ 6V	14.5 / 201.4	12.5 / 173.6
Transit Time ( sec/ 60° )@ 6V	0.108	0.13
Voltage Range	4.8V ~ 6V	4.8V ~ 6V
Traveling Angle	90°/180°	90°/180°

### Precaution

A typical characteristic of digital servos is their high current consumption compared to non-digital servos. For this reason, the use of high capacity NiCd or NiMH batteries is recommended.

To achieve the best performance, an FM radio control system is recommended due to its more precise pulse signal processing.

If you are using an AM radio system, the Battery Eliminator Circuit (BEC) of most AM receivers will limit the current supplied to the servo. Bypassing the BEC with a "Y" harness is recommended.

Using radio systems with a "fail safe" function will result in shorter operating time due to the fail safe system's higher voltage cut-off setting.

### Service

Do not return the equipment to the point of purchase as they are not authorized to honor warranty claims or perform service. Remove the radio equipment in question from the model. We recommend using a shipper's tracking service. Team Associated is not responsible for any items lost in transit.

Please include the following with your product return:

1. Your full name, mailing address, telephone number.
2. A note, inside the box, describing in detail the problems you are having or the service you are requesting.
3. A copy of the original sales receipt.

Once received, warranty service will be performed and items returned promptly. You will be notified by telephone when an item does not fall under the terms of the warranty and service charges are required.

**Please see [www.rc10.com/rc/replacexp](http://www.rc10.com/rc/replacexp) for details regarding Team Associated's XP Lifetime Product Replacement Policy.**

### Parts List

Item Name	29167	29166
A UP / LOW CASE SET	29211	29211
B GEAR SET	29210	29209
C ACCESSORY PACKAGE	29212	29212

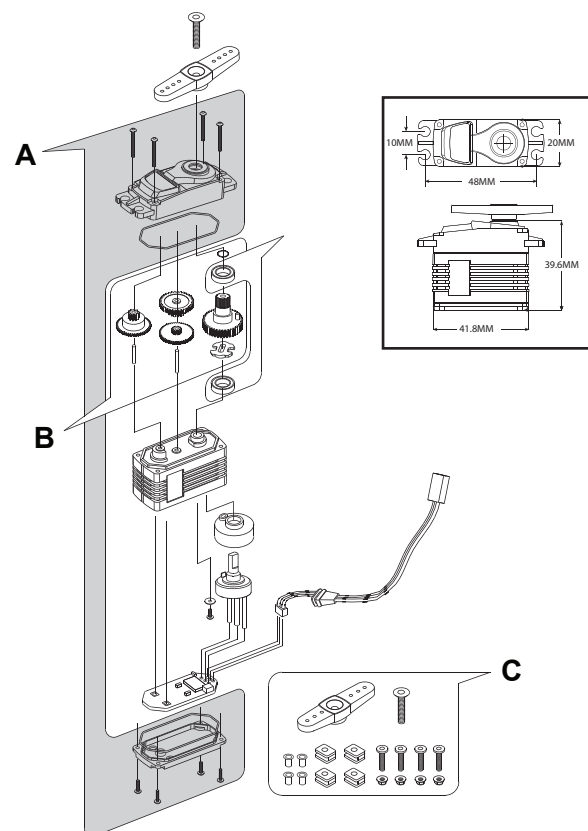

**Associated Electrics, Inc**  
**26021 Commercentre Dr.**  
**Lake Forest, CA 92630 USA**  
**[www.rc10.com](http://www.rc10.com)**